

# MotorGuide® REPAIR PARTS

**Models:**  
**GW50RF**

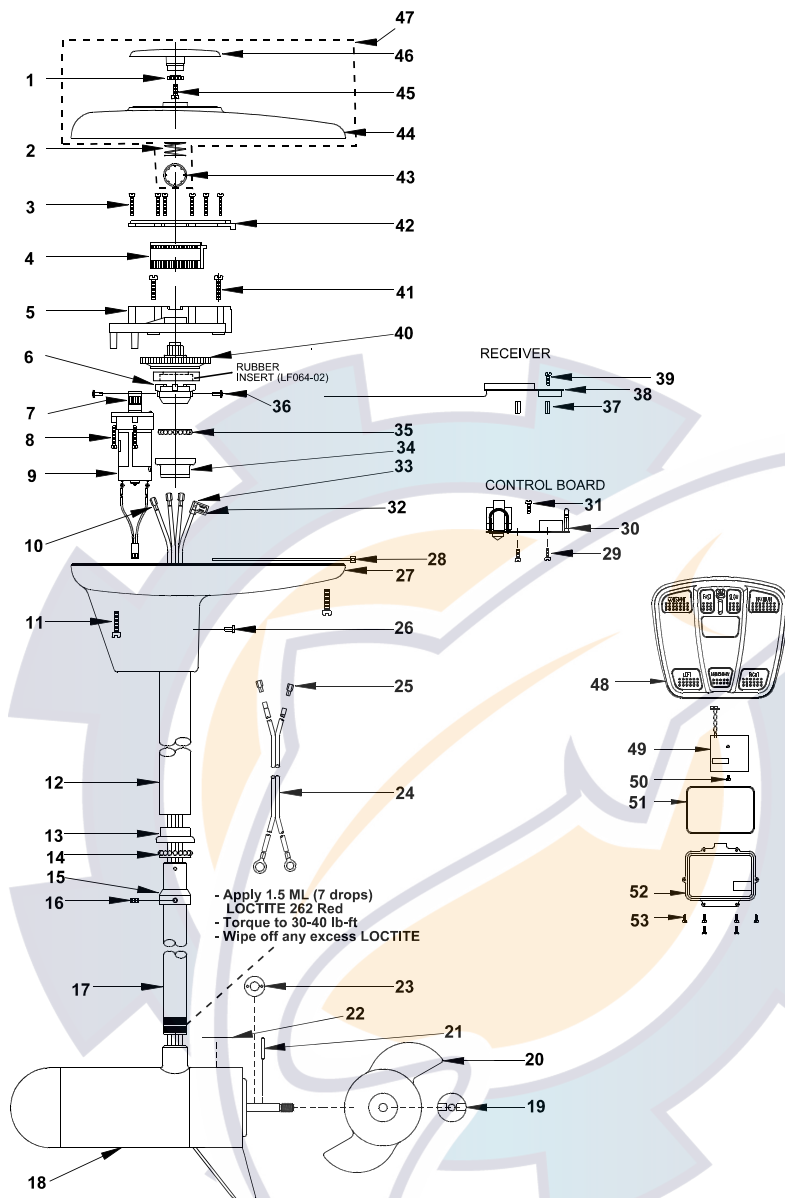

**SPECIFICATIONS:**  
 Year of Intro 1996  
 Thrust 55LBS  
 Volts 24VDC  
 Amp Draw 0 to 33 amps  
 Mount 20 Bow  
 Speeds Variable

**QUICK REFERENCE PARTS GUIDE:**  
 MOSFET JF096-08  
 Motor Seal Kit 6220  
 Transmitter NP169-01

**PARTS ORDERING & TECH ASSISTANCE**  
 MotorGuide Consumer Relations  
 Phone 918-831-6989  
 Fax 800-982-8093  
**Send Returned Goods to:**  
 MotorGuide  
 605 Hwy 12 West  
 Starkville, MS 39760

*Returned Goods must be accompanied with a Returned Goods Authorization. Contact MotorGuide Consumer Relations to obtain RGA.*

KEY#	PART#	DESCRIPTION	KEY#	PART#	DESCRIPTION	KEY#	PART#	DESCRIPTION
1	LF078-06	LAZER GEAR/INDICATOR	18	JF397-14	F/O MOTOR	38	LF170-01	RECEIVER
2	LF014-01	SPRING/INDICATOR	19	AR099-01	PROP NUT	39	IR133-01	SELF TAPPING SCREW
3	LF141-02	SCREW #4 X 7/8	20	AF124-05	3.5 NINJA 2 BLADE PROP	40	LF69-08	LARGE PINION GEAR
4	LF125-01	RACK	21	BR102-01	PROP DRIVE PIN	41	LF141-03	SCREW #8X3/4
5	LF126-01	RACK GUIDE	22	LF060-04	LOWER UNIT DECAL LAZER	42	LF127-01	RACK GUIDE COVER
6	LF064-01	COLUMN COUPLER	23	RK171-01	NYLON WASHER .125" THICK	43	LF098-01	TINNERMAN CLIP
7	LF068-03	PINION GEAR	24	LF328-01	BATTERY CABLE ASY	44	LF053-11	LAZER GENERIC TH COVER
8	LF141-02	SCREW #4 X 7/8	25	PM160-01	TERMINAL	45	LF141-06	SCREW #6X1/2 PLASTIC
9	LF3126-02	DRIVE MOTOR ASSY 24V	26	LF111-02	POP RIVET .126-.187 D6	46	LF078-09	LAZER INDICATOR
10	PM160-01	TERMINAL	27	LF004-03	T/H BASE	47	LF053-11	LAZER TH COVER ASSY
11	XF141-04	SCREW #8 X 1"	28	AF030-01	CABLE TIE	48	NP300-06	LAZER PEDAL ASY
12	AF165-06	(46") OUTER TUBE	29	XT141-01	SCREW, SELF TAPPING	49	NP157-01	TRANSMITTER
	AF165-07	(30") OUTER TUBE	30	LF157-02	LAZER 24V ES/RF BOARD	50	NP133-01	SCREW
	AF165-08	(36") OUTER TUBE	31	XF141-01	SELF TAPPING SCREW	51	NP063-02	GASKET ORING
	AF165-01	(13") OUTER TUBE	32	BR161-03	20-14 FLAG TERM/STRIP G2	52	NP053-06	BATTERY DOOR
13	AF007-01	RETAINER/ BEARING CUP	33	AT080-01	INSULATING SLEEVE	53	AF135-01	SCREW
14	AF005-01	BEARING	34	FM007-01	BEARING CUP			
15	AF006-01	RETAINER/BEARING	35	FM005-01	BALL BEARING			
16	AF143-01	SET SCREW	36	LF111-01	POP RIVET .376-.500 D6			
17	LF049-03	36" SS COLUMN	37	LF102-03	STANDOFF			
	LF049-04	42" SS COLUMN						
	LF049-05	50" SS COLUMN						

**PARTS NOT ILLUSTRATED**  
 LF056-12 TOP HOUSING DECAL

Models:  
**GW50RF**

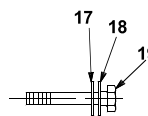
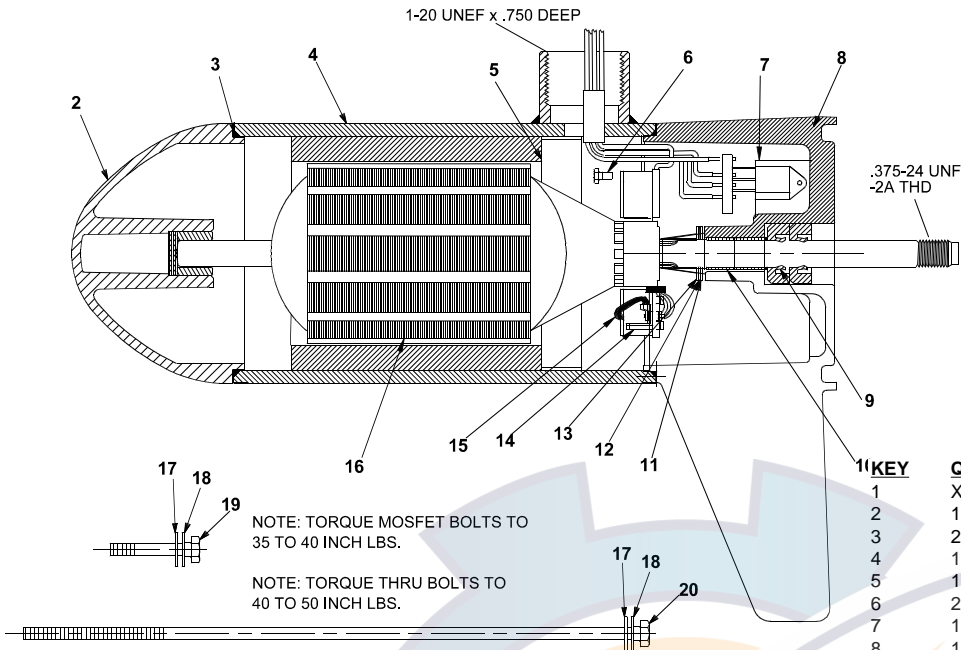

NOTE: TORQUE MOSFET BOLTS TO 35 TO 40 INCH LBS.

NOTE: TORQUE THRU BOLTS TO 40 TO 50 INCH LBS.

DIRECTION OF ROTATION IS COUNTER CLOCKWISE WHEN VIEWED FROM PROPELLER END WITH RED POSITIVE & BLACK NEGATIVE.

KEY	QTY	DESCRIPTION	PART NO.
1	X	MOTOR	JF397-14
2	1	NOSE CAP	JF3212-02
3	2	O RING SEAL	MR217-01
4	1	HOUSING ASY	JF3210-02
5	1	RETAINER	JF233-01
6	2	BRUSH CARD SCREW	MR228-01
7	1	DURA AMP MODULE	JF096-08
8	1	COMM CAP	UF3205-02
9	2	SHAFT SEAL	MR223-01
10	1	BEARING	MR206-01
11	1	NYLATRON WASHER	MR226-01
12	1	WASHER	MR227-01
13	1	E RING	MR219-01
14	2	BRUSH SPRINGS	MR214-02
15	1	BRUSH ASY LESS SPRING	JF3201-05
16	1	ARMATURE 3.5"	JF3207-01
17	4	STATIC SEAL	MR222-01
18	4	THRU BOLT WASHER	MR216-02
19	2	DURA AMP SCREW	MR229-02
20	2	THRU BOLT	MR218-03

### WIRING

